

RESOURCE CENTER

Bitwarden initial setup tutorial – Edge browser and SSO

Easily get started using the Bitwarden Password Manager Edge extension

Get the full interactive view at
<https://bitwarden.com/nl-nl/resources/bitwarden-initial-setup-tutorial-edge-browser-and-sso/>



#1 Download the Bitwarden Edge browser extension.

Install the extension to securely manage your passwords in Edge download by going to <https://bitwarden.com/download/> | Watch [short video](#)

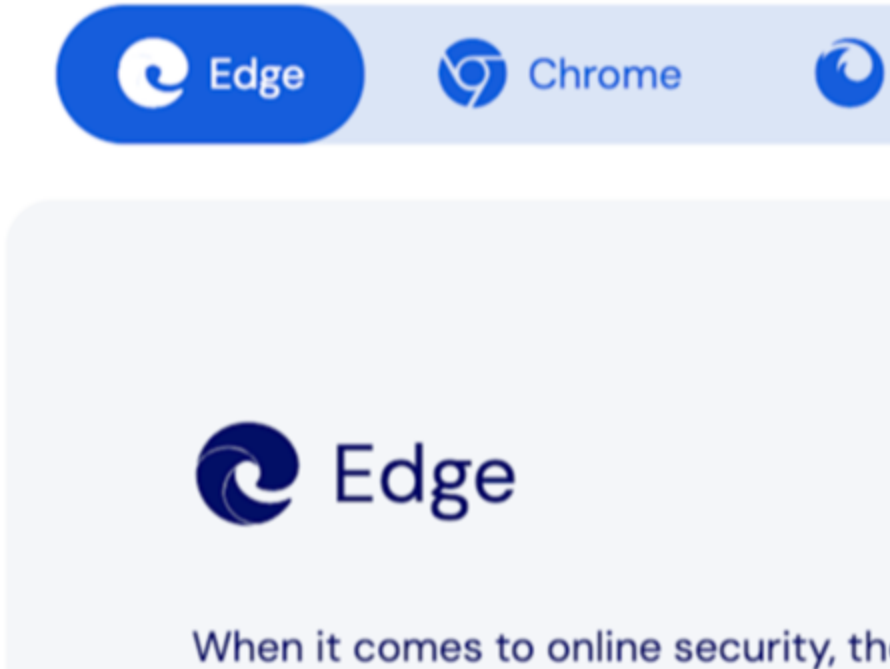

Download edge extension

#2 Pin the Bitwarden browser extension to the taskbar for easy access.

Keep Bitwarden readily accessible by pinning it to your browser toolbar. | [Watch short video](#)



Edge browser extension - Pin to taskbar

#3 Turn off the built-in browser password manager

Prevent conflicts and ensure a seamless experience by disabling the browser's password manager. | [Watch short video](#)

Passwords

Offer to save passwords Allow Microsoft Edge to save your passwords and help keep them secure	<input type="checkbox"/>
View and autofill passwords and passkeys Allow Microsoft Edge to automatically fill passwords and suggest available passkeys.	<input type="checkbox"/>
Scan for leaked passwords To use this setting, sign in to Microsoft Edge	<input type="checkbox"/>

Disable native password manager

#4 Sign in with Enterprise SSO (If your organization is using SSO)

Quickly access Bitwarden using your company's Single Sign-On (SSO). | [Watch short video](#)

The screenshot shows the Bitwarden sign-in interface. It features an input field for 'Email address (required)', a 'Remember email' checkbox, and three buttons: 'Continue', 'Log in with passkey', and 'Use single sign-on'. The 'Use single sign-on' button is highlighted with a red box.

Sign in with SSO

#5 Save your first item in the Bitwarden extension

Start securing your credentials by adding your first login entry. | [Watch short video](#)

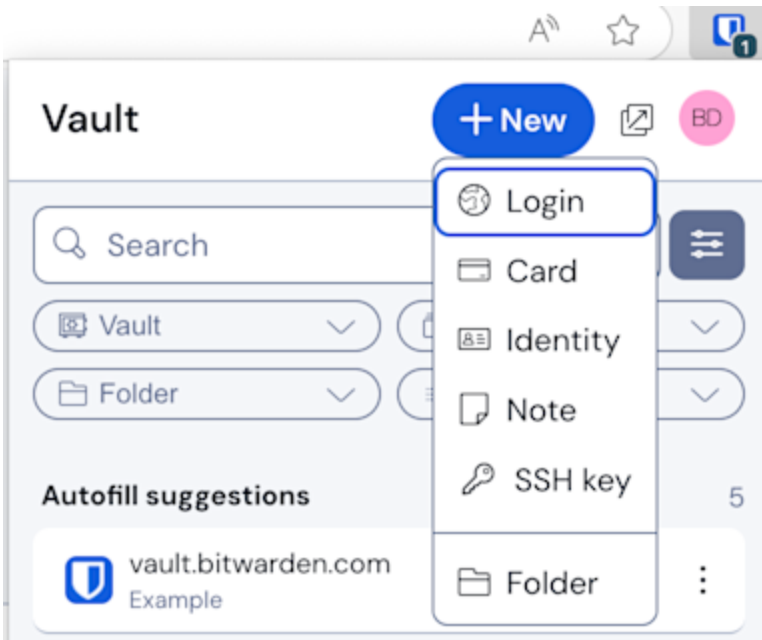

Add new item to vault