

PASSWORD MANAGER > BITWARDEN SEND

Send Privacy

View in the help center:
<https://bitwarden.com/help/send-privacy/>

Send Privacy

Protect the contents of your Send by configuring a [password for access](#) so unintended recipients can't see the information, and/or to [hide your email](#) from recipients. For text Sends, you can also optionally require recipients to [toggle visibility](#) to prevent exposure to unintentional onlookers.

The **Password**, **Hide Email**, and **Hide Text** options can be set while creating a new Send, or from the **Edit Send** view at any time prior to the Send's [deletion](#).

Send passwords

For any Send, you can set a password that recipients will be required to enter in order to access it. Password-protecting a Send is a good way to ensure the information in it is not exposed to unintended recipients:

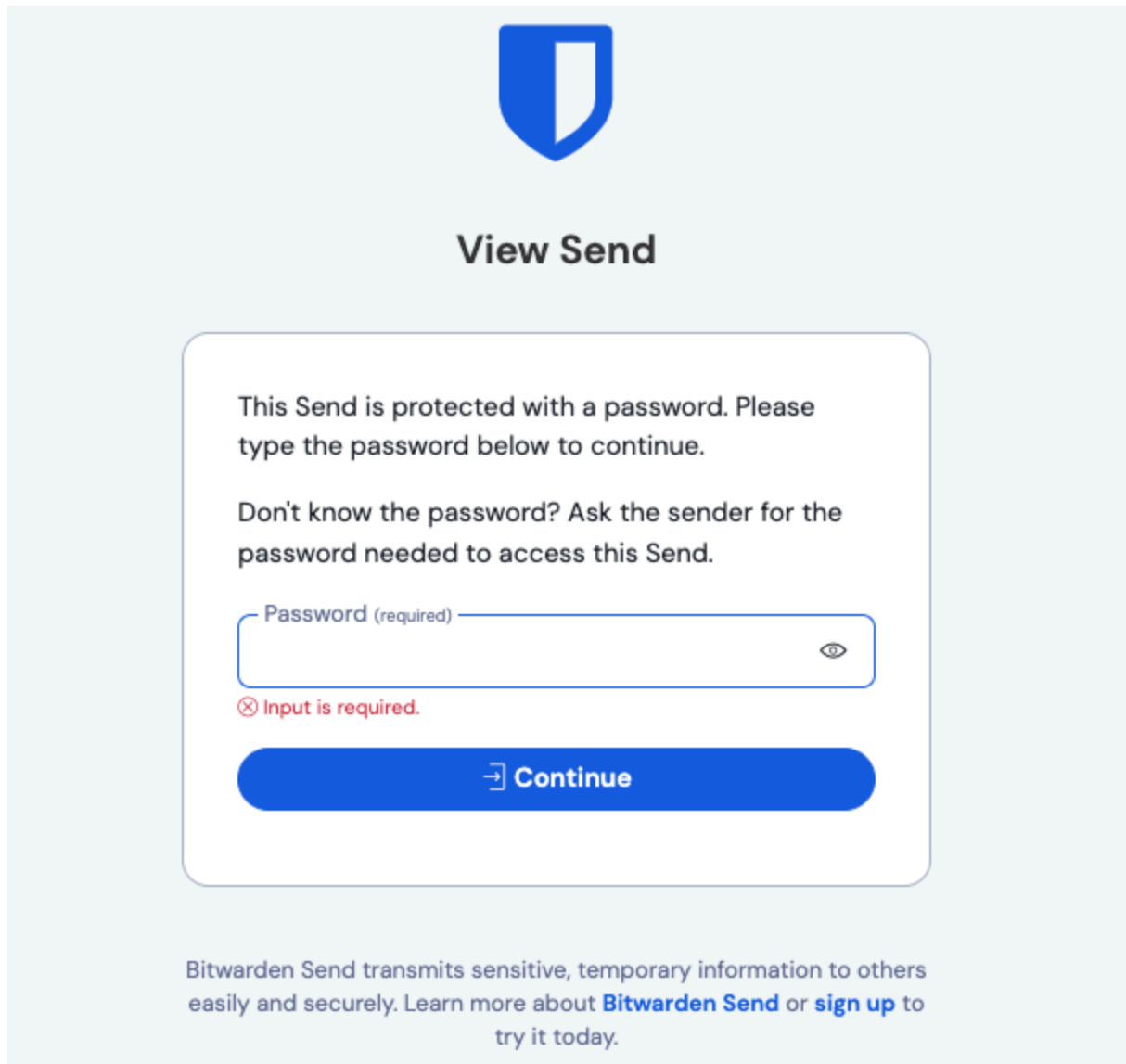

Receiving a password-protected Send

Once you password-protect a Send, you won't be able to view the configured password again, however you can [change](#) or [remove](#) it at any time.

Change Send passwords

You can change a Send's password at any time from the **Edit Send** view. Changing a Send's password will not require you to enter the previous password. When changing a Send's password, the **Password** field will change to **New Password**.

Remove Send passwords

You can remove a Send's password at any time using the  **Remove Password** menu option. Removing a Send's password will not require you to enter the previous password:

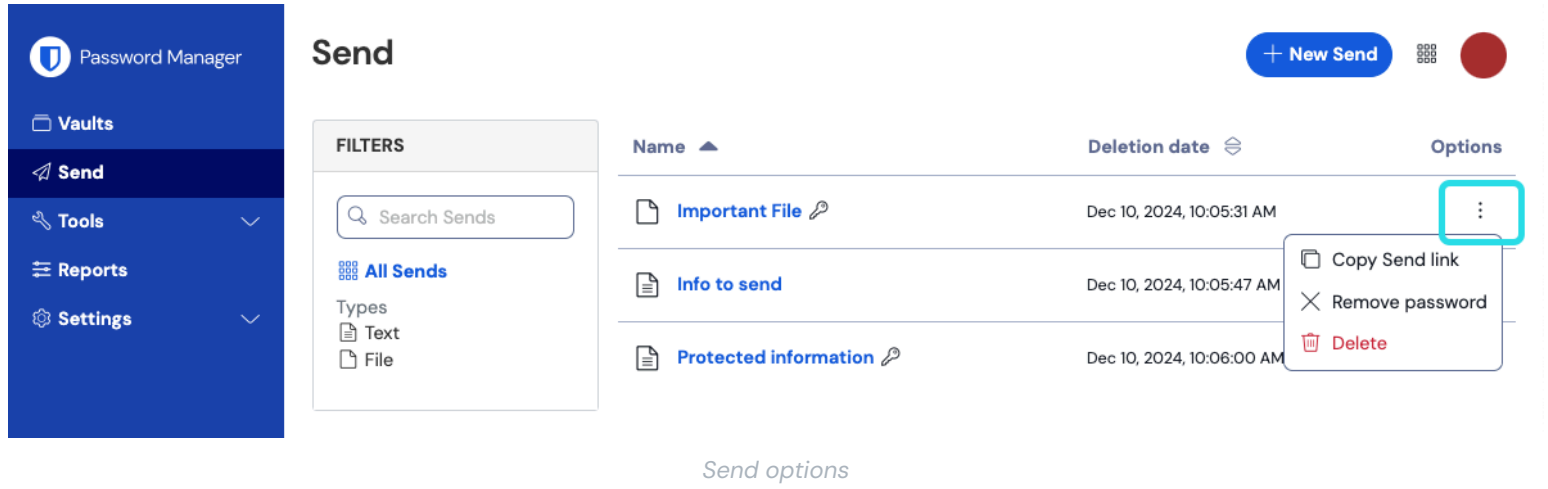

The screenshot shows the Bitwarden interface for managing 'Sends'. On the left is a navigation sidebar with 'Send' selected. The main area is titled 'Send' and contains a table of sends. A context menu is open for the 'Important File' send, showing options: 'Copy Send link', 'Remove password', and 'Delete'. Below the table is the text 'Send options'.

Name	Deletion date	Options
Important File	Dec 10, 2024, 10:05:31 AM	Copy Send link, Remove password, Delete
Info to send	Dec 10, 2024, 10:05:47 AM	
Protected information	Dec 10, 2024, 10:06:00 AM	

Hide email

Tip

For enterprise organizations, the availability of this option can be set using an [enterprise policy](#).

By default, Sends will display the email address of the sender to recipients.



View Send

Warning

The Bitwarden user who created this Send has chosen to hide their email address. You should ensure you trust the source of this link before using or downloading its content. [Learn more.](#)

Info to send

██████████

 Copy value

Bitwarden Send transmits sensitive, temporary information to others easily and securely. [Learn more about Bitwarden Send](#) or [sign up](#) to try it today.

Hidden-email text Send

Toggle the **Hide my email address from recipients** option to remove your email address from the Send. Recipients can still validate the trustworthiness of expected Sends by cross-referencing the **Send link** with their sender. Hidden-email send objects will issue a warning to recipients encouraging them to do so:

Hide text

For text Sends, toggle the **When accessing the Send, hide the text by default** option to require recipients to **Toggle Visibility** in order to see its contents. Hiding the text is a good way to ensure the information in it is not exposed to unintentional onlookers:

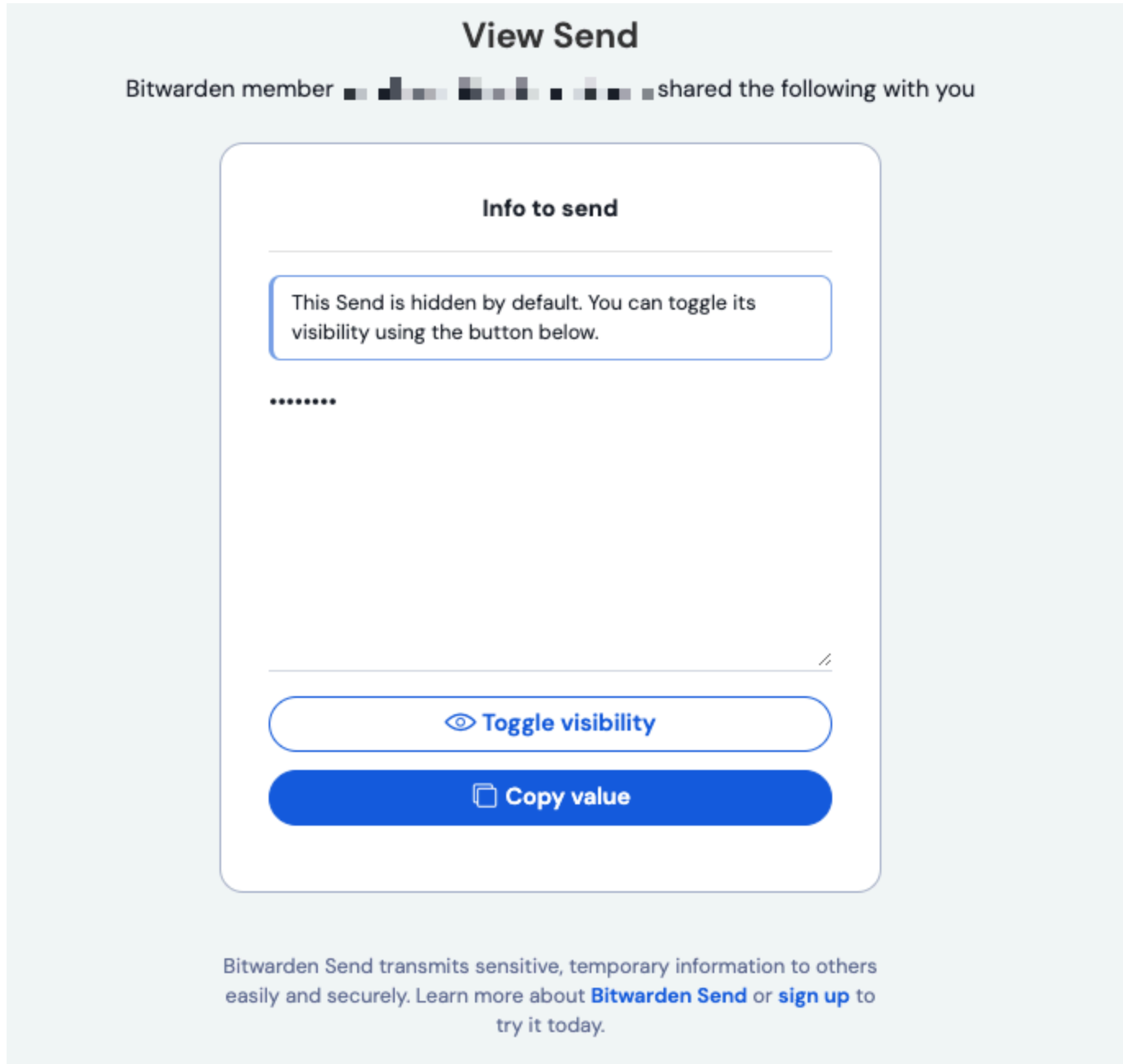

Receiving a hidden-text Send