

RESOURCE CENTER

# Bitwarden initial setup tutorial – Edge browser and SSO

Easily get started using the Bitwarden Password Manager Edge extension

Get the full interactive view at  
<https://bitwarden.com/fr-fr/resources/bitwarden-initial-setup-tutorial-edge-browser-and-sso/>



## #1 Download the Bitwarden Edge browser extension.

Install the extension to securely manage your passwords in Edge download by going to <https://bitwarden.com/download/> | Watch [short video](#)

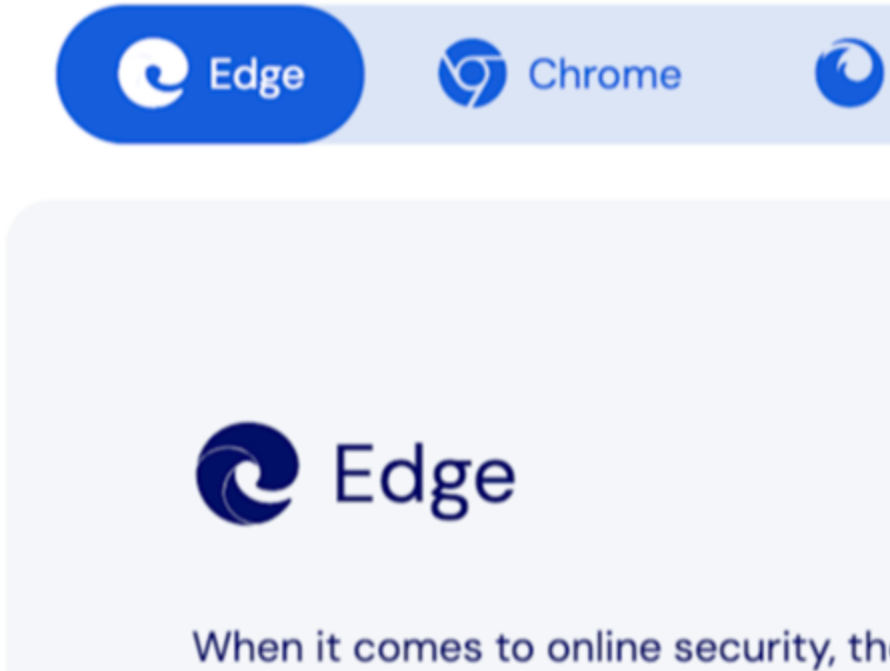

Download edge extension

## #2 Pin the Bitwarden browser extension to the taskbar for easy access.

Keep Bitwarden readily accessible by pinning it to your browser toolbar. | [Watch short video](#)

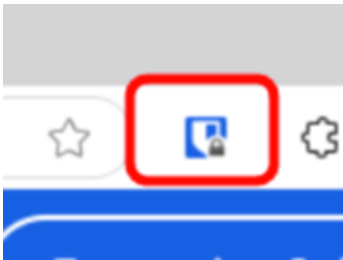

Edge browser extension - Pin to taskbar

## #3 Turn off the built-in browser password manager

Prevent conflicts and ensure a seamless experience by disabling the browser's password manager. | [Watch short video](#)

## Passwords

<b>Offer to save passwords</b> Allow Microsoft Edge to save your passwords and help keep them secure	<input type="checkbox"/>
<b>View and autofill passwords and passkeys</b> Allow Microsoft Edge to automatically fill passwords and suggest available passkeys.	<input type="checkbox"/>
<b>Scan for leaked passwords</b> To use this setting, sign in to Microsoft Edge	<input type="checkbox"/>

Disable native password manager

### #4 Sign in with Enterprise SSO (If your organization is using SSO)

Quickly access Bitwarden using your company's Single Sign-On (SSO). | [Watch short video](#)

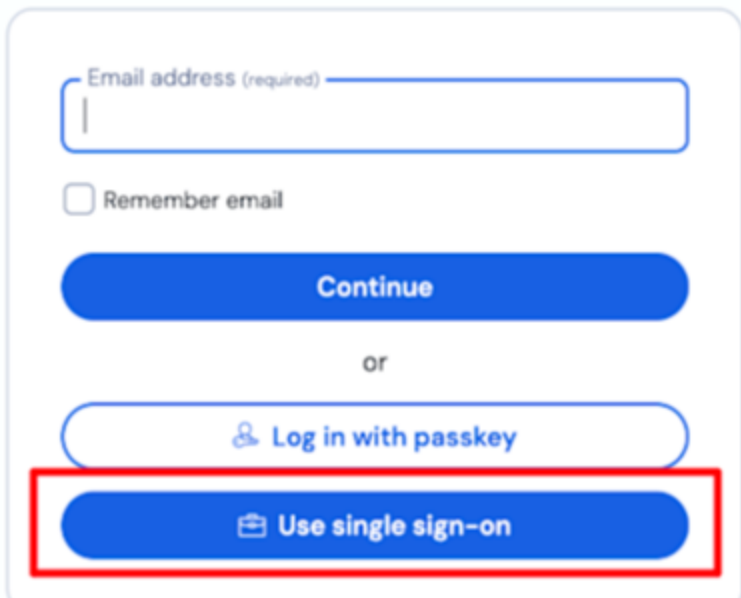

Sign in with SSO

### #5 Save your first item in the Bitwarden extension

Start securing your credentials by adding your first login entry. | [Watch short video](#)

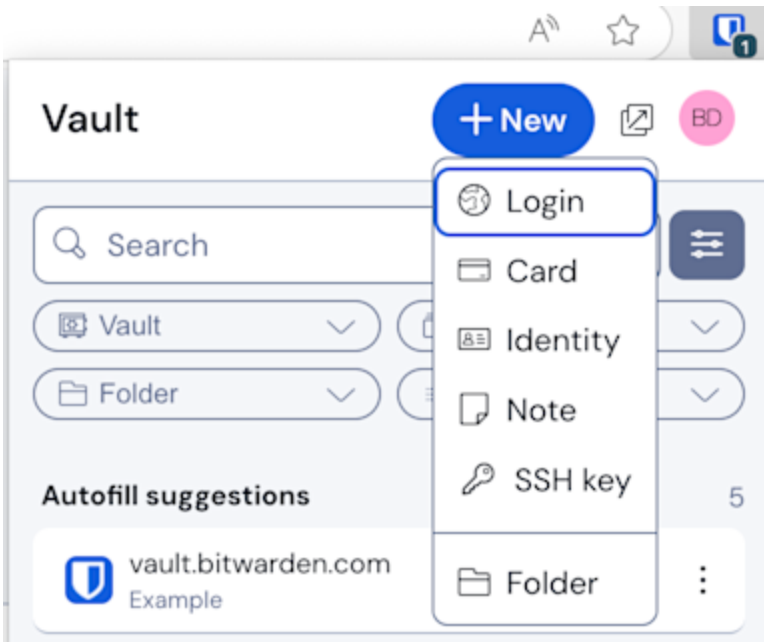

Add new item to vault